

**Behroyan & Associates Real Estate
Services Ltd.**

Phone:
Mobile: 604-716-0005
Fax: 604-281-3343
Email: naz@behroyan.ca

1495 Clyde Avenue
West Vancouver, BC
V7T 1E9

2275 Kelly Avenue, Port Coquitlam , BC, V3C 1Y1, Canada

MLS®# R2302476

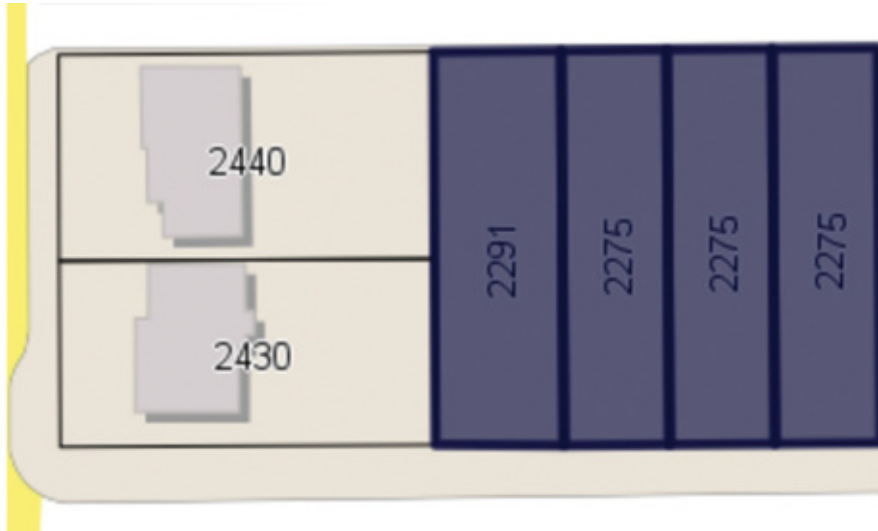

Property Value	\$6,998,000
Type	2 storey house
Style	K-5 Central Community Elementary, 6-8 Pitt River Middle, 9-12 Ri
Year Built	9999
Taxes	2269.18
Living Area	1,700 sq.ft.
Lot Frontage	32.56 ft
Lot Depth	122.88 ft
Lot Size Area	17,113 sq.ft.
Bedrooms	2
Bathroom	1 full
School District	Port Coquitlam

Description

Development site! Permit application near completion. Permits in process for 58,081sqft buildable with 47 units in total. This lot will be sold in conjunction with 2291 Kelly Avenue. Both lots will be sold together making it a perfect opportunity to build a multifamily in a hot condo market. Please call for more information or to view.